

STRONG
READY TO WORK

ST100 MINI EXCAVATOR



Total weight	1000kg	Max. dumping height	1910mm
Total length	2780mm	Min. ground clearance	385mm
Total width	930mm	Engine brand	LG
Total height	2220mm	Engine model	192F
Max. digging radius	2800mm	Output power	8.2kw
Max. digging depth	1500mm	Walking speed	0-1.44km/h
Max. digging height	2480mm	Climbing angle	30%

The lever heads are all round, making it more comfortable to operate.

The whole vehicle pin pump is made of 40 chrome material, which is rough machined, quenched, finely ground, galvanized, wear-resistant and not easy to rust.

Welding robot welding, the welding seam is well fused, and the service life is long.

The stamping shield has a more beautiful appearance and is not deformed or out of shape. Air vents on both sides ensure that the hot air in the cabin is exhausted.

The inspection cover can be opened, which is very convenient for daily inspection of oil pipes and machine repairs.

Using herringbone track, walking on hard ground is more stable.

It adopts mechanical tension, simple structure, low maintenance products and long service life.

The travel motor mounting seat is a double-point support, which has higher strength and is not easy to deform.

The one-piece forged cylinder rod is used, which will not break and has higher precision. The cylinder diameter is enlarged to increase the digging force.

The connecting rod rocker is made of cast steel and processed by a machining center, which has higher machining accuracy and longer service life.

The butter filling port is externally located, which is convenient for daily maintenance.

The support rollers increase the retaining ring, the frame is not stressed, and the use time is long.



Increase the main power switch to prevent the excavator from being powered on when it is placed.

The fuel filler port is externally located, which is convenient for refueling and observing the oil level.

The wiring harnesses all use international wires, and the connectors are all imported connectors, which is convenient for later replacement of accessories.

The thickness of the large bottom plate of the upper frame is 12mm, the weight is 105KG, and the strength is high. The rib plate in the car body runs through the whole car and exists independently and has high overall strength.

The central rotary joint has an additional oil drain hole to prevent the internal pressure from being too high and damaging the central rotary.

The slewing support is equipped with a guard plate to prevent foreign objects from damaging the slewing support and protect the slewing support from working normally.

The use of high-quality engineering rubber alkali shock absorbers, the shock absorption effect is good, and the thickness of the engine bracket plate is up to 8mm.

- ① The gears of the rotary motor are in the form of splines, and the transmission torque is large and not easy to be damaged.
- ② The gear is made of 42CrMo (42 chrome molybdenum) material, and the wear resistance of the gear is improved by surface nitriding, grinding and other processes.

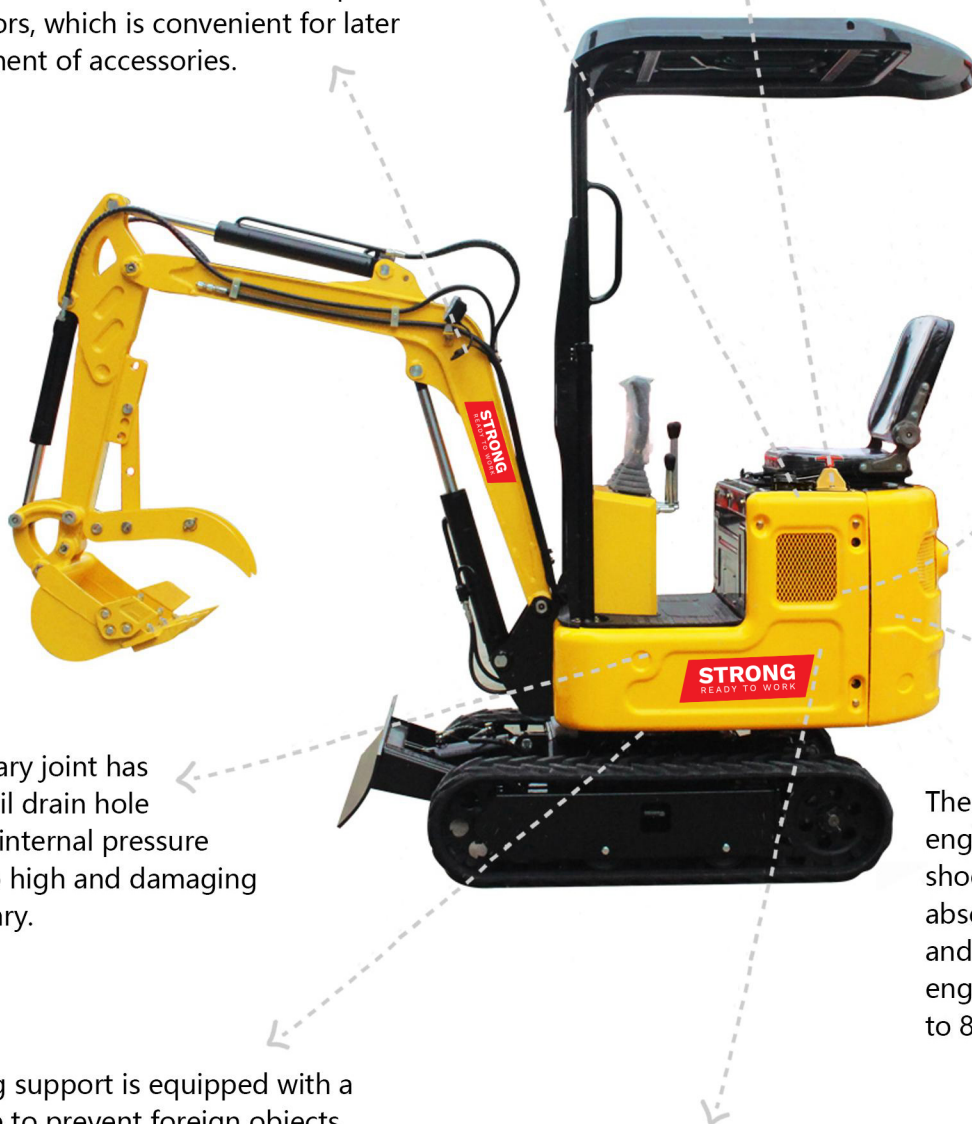

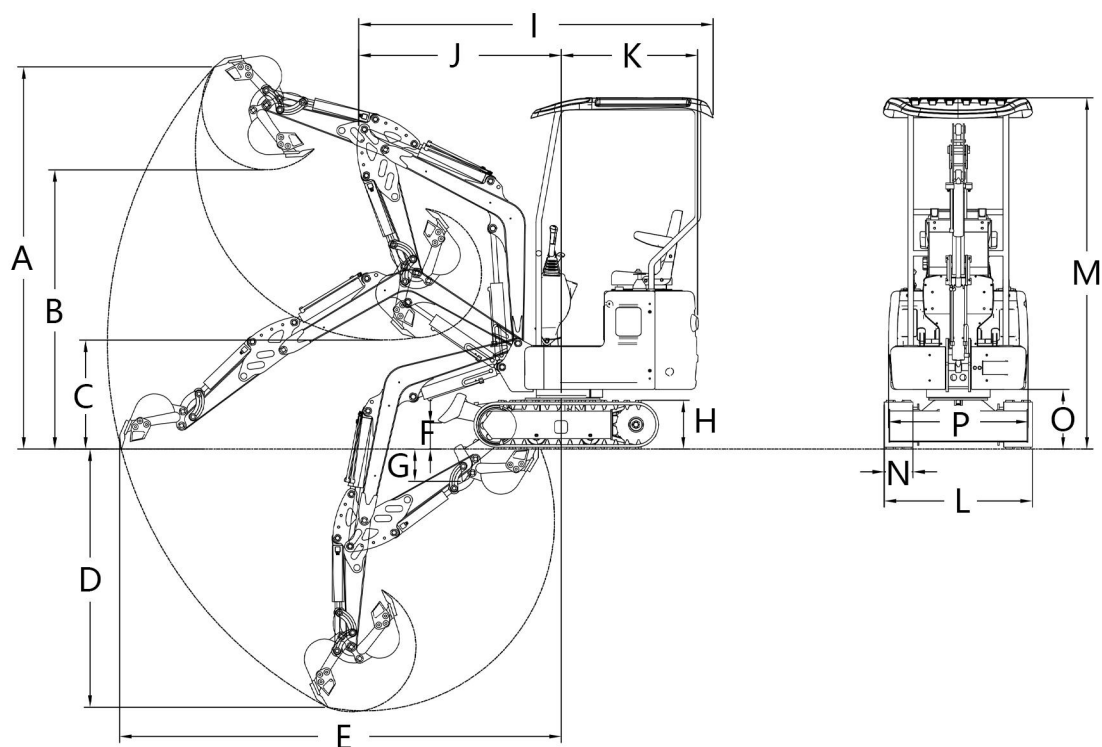

A	2407mm	E	2781mm	I	2300mm	M	2211mm
B	1758mm	F	165mm	J	1275mm	N	180mm
C	687mm	G	203mm	K	859mm	O	376mm
D	1625mm	H	308mm	L	932mm	P	878mm

Brand engine



Kubota



LG

Hydraulic cylinder



Quality tubing



Travel motor

