

STRONG
READY TO WORK

ST200



Total weight	2000kg	Max. dumping height	2250mm
Total length	4050mm	Min. ground clearance	415mm
Total width	1300mm	Engine brand	Kubota
Total height	2300mm	Engine model	D902
Max. digging radius	4023mm	Output power	11.8kw
Max. digging depth	2250mm	Walking speed	0-1.8km/h
Max. digging height	2951mm	Climbing angle	30%

The whole vehicle pin shaft is made of 40 chrome material, which is rough machined, quenched, finely ground, galvanized, wear-resistant and not easy to rust.

High-pressure iron pipe is used, which has a long service life and is not easy to be damaged.

The cylinder rod is forged in one body, with higher precision, the diameter of the cylinder is enlarged, and the digging force is increased.

The oil pipe is arranged in the arm body, which greatly prolongs the life of the joint oil pipe.

With a breaker stop valve, installing a breaker can effectively prevent oil leakage from the broken oil pipe.

Using the same armrest box and instrument of Viknussen, the operation is more comfortable, and the instrument data is more detailed, which is convenient to understand the various parameters of the excavator.

The connecting rod rocker is made of cast steel and processed by a machining center, which has higher machining accuracy and longer service life.

The excavator adopts a pilot lock to prevent accidental touch and make it safer to operate.

The central rotary joint has an additional oil drain hole to prevent the internal pressure from being too high and damaging the central rotary.

It adopts Zhenjiang Dali Motor BMV-500 motor, which has reliable performance and large torque, and can be applied to a variety of complex roads.

The bulldozer adds wear-resistant plates to prevent the stress during bulldozing and increase the service life.

Oil-filled tensioning, easy and quick to release tensioning, not easy to damage.

The bulldozer adds oil cylinder guards to ensure that the lever is not damaged, and the oil pipes are arranged inside the car body, which can effectively protect the oil pipe joints and wearing parts.

The rollers are added with retaining rings, the frame is not stressed, and the use time is long.

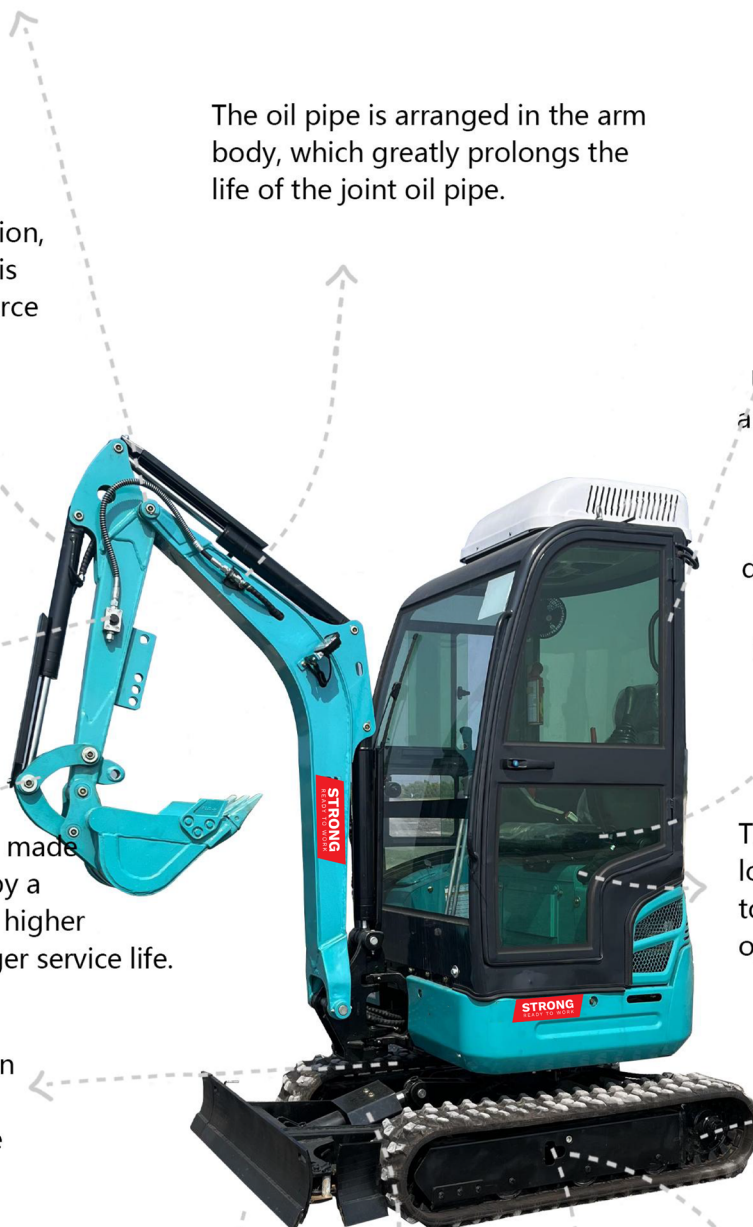

The armrest box is equipped with a hand rest, which is convenient for long-term operation.

The refueling port is located outside for easy refueling and has a special lock for more security.

The high-quality engineering rubber shock absorber is used, which has a good shock absorption effect, and the thickness of the engine bracket is up to 12mm.

The stamping guard has a more beautiful appearance, no deformation and no distortion, and the large air vent ensures the hot air in the cabin to be discharged.



The swing motor has a two-way relief valve for protection of the internal components of the motor and smooth operation.

Deflectable boom, multi-degree-of-freedom operation, large deflection angle, more flexible operation, and can meet more job requirements.

Lead the intake pipe to the outside, so that the engine maintains sufficient intake air, so that the fuel burns more fully, and it saves fuel and energy.

The access cover is flip-up type, which is very convenient for daily inspection and machine repair.

The volume of the auxiliary water tank is 2L, and all parts are tightly sealed to ensure that the water tank does not need to be frequently filled with coolant.

The split type super fan heater can ensure that the excavator is not high temperature under high temperature and long-term working conditions.

The brushless AC internal regulation generator is used, no external regulator is needed, and the generator directly sends out DC power, which is more stable.



The wiring harnesses all use national standard wires, and the plug connectors are all imported plug connectors, which are convenient for later replacement of accessories, and an integrated fuse box is used to facilitate maintenance and inspection.



The car is isolated from the engine compartment and the car body, and is blocked with thermal insulation cotton to prevent the hot steam from the engine from steaming the cab.

The bottom plate is retractable, widening the bottom plate can make walking more stable, shortening the bottom plate, can enter the narrow road, can be expanded and retracted arbitrarily according to your own requirements, and the work is not limited by space.

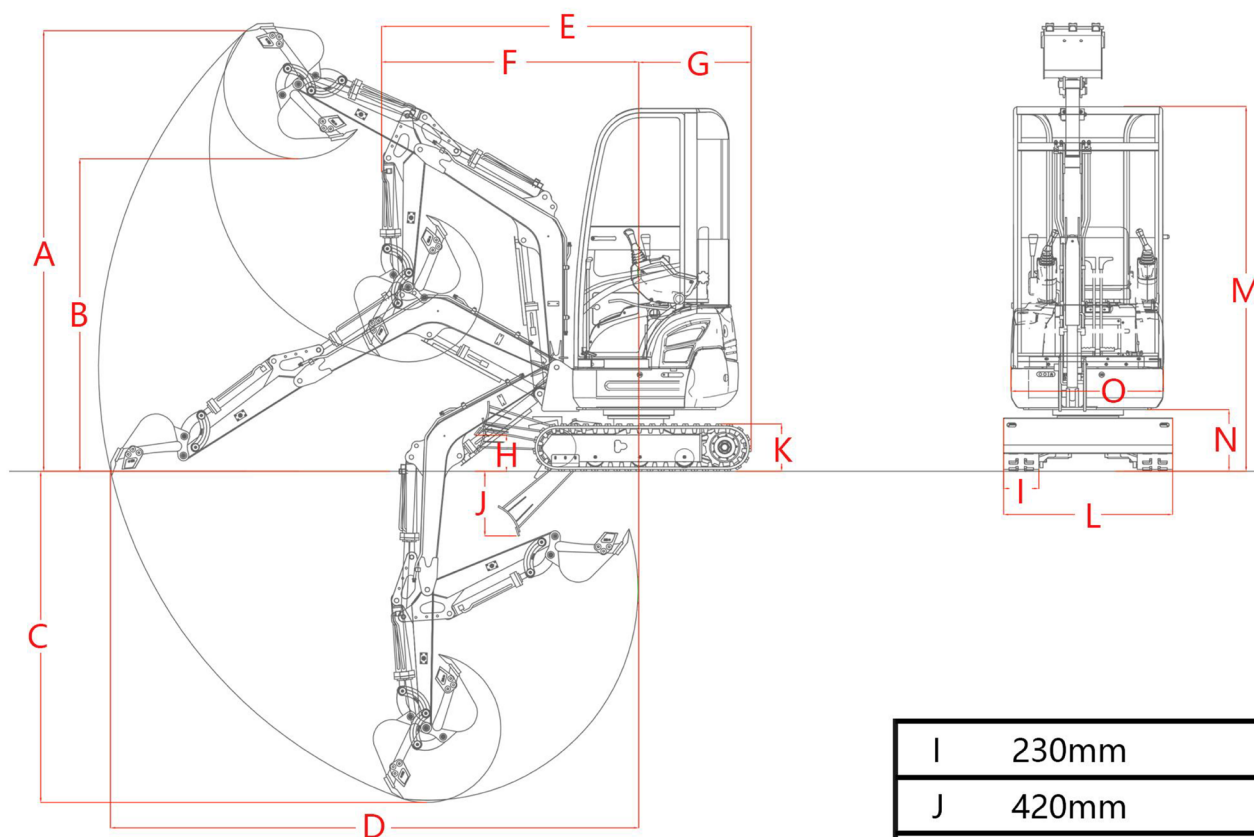

		I	230mm
		J	420mm
		K	308mm
A	2860mm	E	2450mm
B	2030mm	F	1673mm
C	2150mm	G	723mm
D	3430mm	H	234mm
		L	1100mm
		M	2375mm
		N	402mm
		O	990mm

Kubota

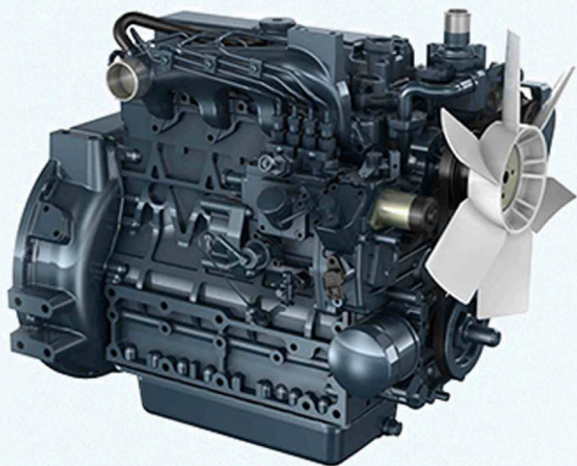

Using Kubota engine, stable performance, strong power, high work efficiency, energy saving and environmental protection

Deflectable boom

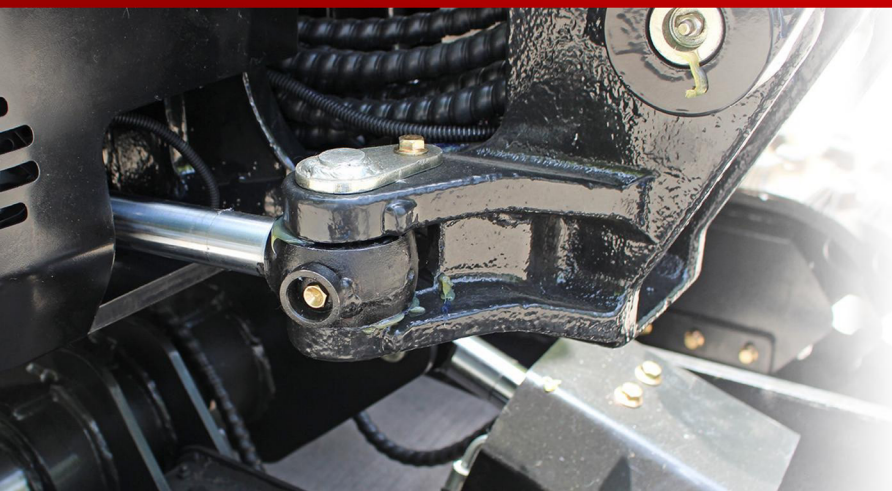

Deflectable boom, multi-degree-of-freedom operation, large deflection angle, more flexible operation, and can meet more job requirements.

Crawler Telescopic



The bottom plate is retractable, widening the bottom plate can make walking more stable, shortening the bottom plate, can enter the narrow road, can be expanded and retracted arbitrarily according to your own requirements, and the work is not